

## TWIN DOOR OUTLET BOX #10408

Includes Adapter Plates for Both Standard and Decora Outlets (Single and Double Screw Outlets).  
For use with various size adapters and plugs.

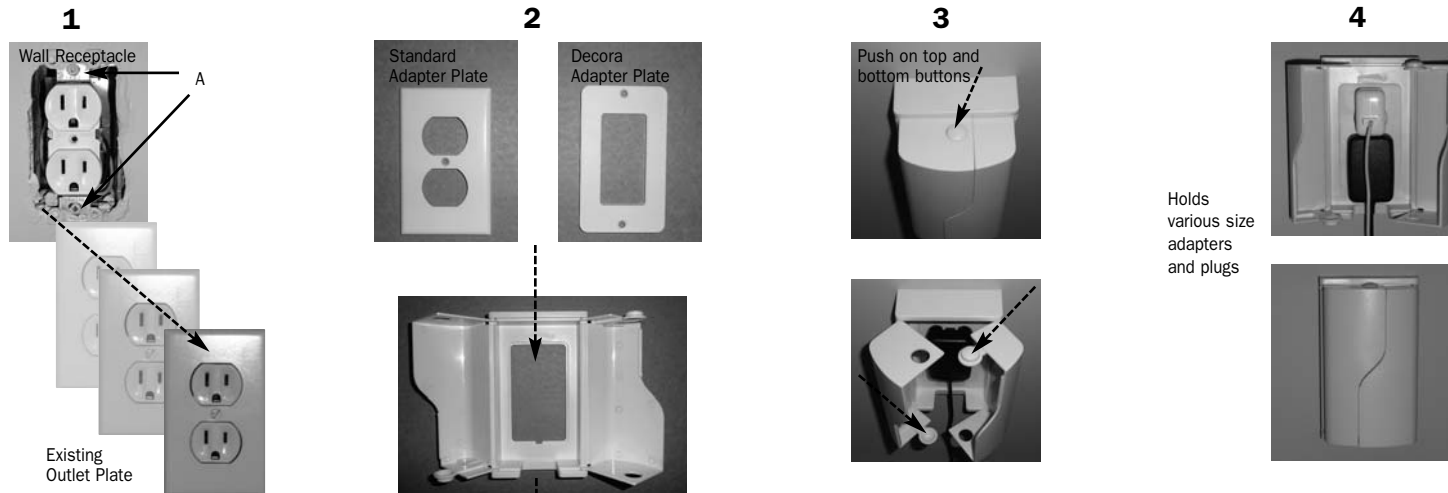

To Install

1. Remove existing outlet plate from the wall receptacle.
2. Insert either the Standard or Decora Adapter Plate into the Twin Door Outlet Box. Attach to the receptacle using the sup-

plied screws. Tip: If the Twin Door Outlet Box does not fit snugly to the wall, remove it and slightly tighten the two screws (A) that hold the receptacle to the wall.

3. To open or close the Outlet Box, push down on the top button and push up on the bottom

button at the same time as you separate the two doors.

Note: Shut off power to outlets before you remove outlet plates since this action may cause dangerous electrical connections to be exposed.

**Safety Innovations™**

Billerica, MA 01821 800-598-8911

