

The Soft Seat Hearth Pad

Fits up to 90" total across front of Hearth
 Call 1-800-845-9236 if Hearth is longer than 90".
 Additional foam maybe needed.

INSTALLATION INSTRUCTIONS

#6500

THANK YOU: For purchasing the Soft Seat Hearth Pad. Please read the instructions before installing the Pad.

TOOLS NEEDED: Measuring Tape, Pencil, Straight Edge, Razor Knife, Rubbing Alcohol, Cloth

Step #1 Place LH & RH Corners on hearth. (Figure 1) If Corners are too deep (wide) to fit on hearth, trim using Pad cutting instructions on back of this page.

Step #2 With LH & RH corners pushed up tight on hearth, measure distance between them. Be sure to measure at the two locations shown. Measure at front and back of Pad. (Figure 1)

Step #3 Add 1/8" to longest measurement and place a pencil mark on Center Connector at the two Locations as shown. Draw line to connect to create cut line. (Figure 2)

Step #4 Cut Center Connector to length using Pad cutting instructions on back of page. If Corners were trimmed for depth, then do same for Center Connector. Be sure to trim the depth from Center Connector lap that rests on top of hearth. **Do not** trim off front flap. (Figure 2)

Step #5 After cutting Center Connector, place it on hearth with the two Corners and make sure it fits correctly.

Step #6 With Center Connector cut to correct length, turn it over so that the v-groove is facing up. Clean v-groove with rubbing alcohol and allow a few minutes to dry. Place the 1/2" wide tape along the v-groove as shown. Make sure tape is placed along top edge of v-groove. (Figure 3)

Step #7 Peel away tape liner from tape and fold up front flap of Center Connector. Be sure to press foam together on outside of pad along the v-groove several times to make sure tape sticks to pad. (Figure 4). *Note: Adhesive requires several hours to completely bond, but installation can be completed without waiting.*

MATERIALS INCLUDED

ITEM	DESCRIPTION	QTY
A	Left Hand Corner	1
B	Right Hand Corner	1
C	Center Connector	1
D	Attachment Tape - 2 in Wide	1
E	V-Groove Tape - 1/2" Wide	1

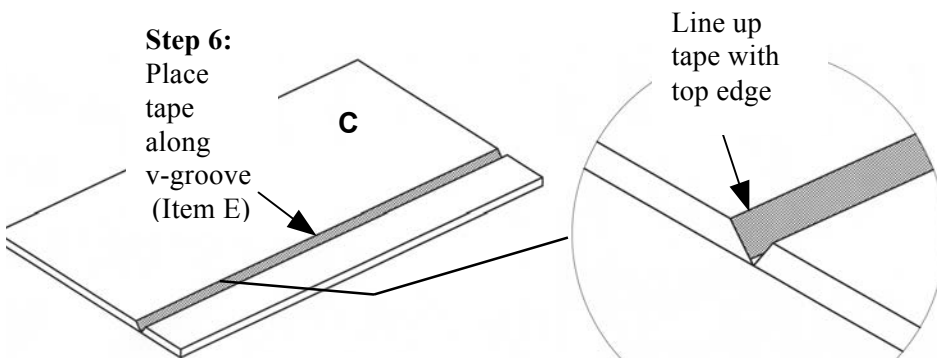
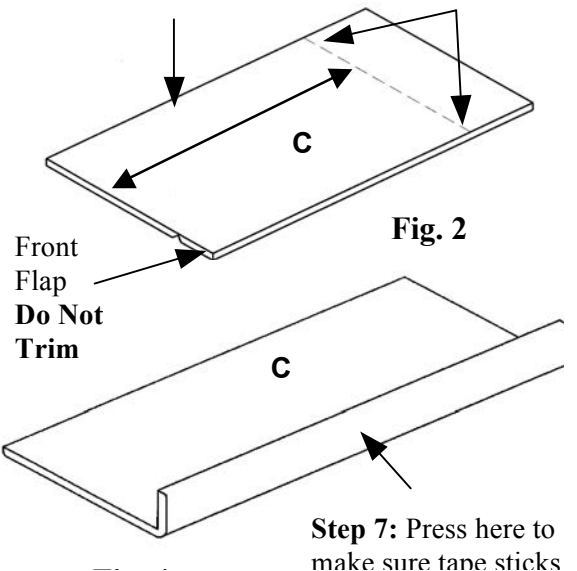
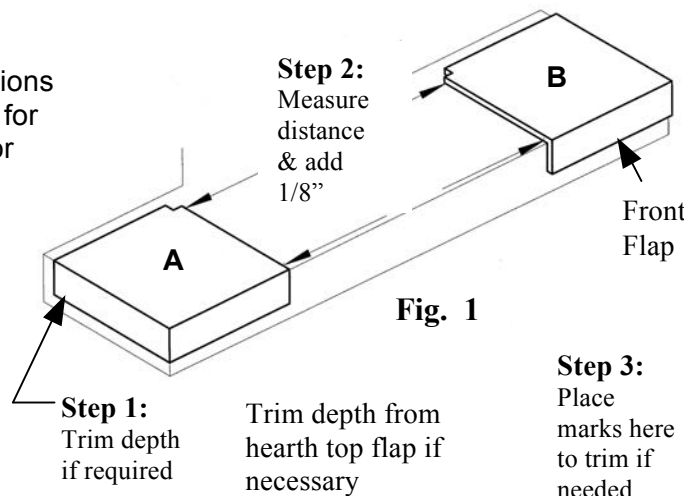

Step #8 With Center Connector's front flap folded up as shown in figure 4, place on hearth with Corners to make sure pad fits correctly.

Step #9 Place Corners and Center Connector on flat surface upside down. Wipe down bottom side edges of pad with rubbing alcohol and allow to dry. Align Corners with Center Connector and push them together tightly. Join Corners to Center Connector with 2" wide double sided tape to create a one piece pad. Do not remove tape liner to expose other side of tape unless you plan to tape directly to hearth. See optional tape attachment instructions.(Figure 5)

Step #10. Place Pad on hearth. Pad should sit snugly on hearth. The Soft Seat Hearth Pad is large enough to sit securely on the hearth without the use of the adhesive tape on hearth. However, for additional security the Pad may be secured to the hearth with the Attachment Tape.

Optional Tape Attachment To Hearth for added Security

Step #1A Place the 2" wide tape strips on Corners as shown on bottom of Pad. (Figure 5)

Step #2A. Place a tape strip on Center Connector in between the joint tape strips. Peel away paper liner on tape strips covering only the joints. (Figure 5)

Step #3A. Wipe down top edges of hearth with rubbing alcohol and allow to dry. Place a 2" wide tape strip along front of top side of the hearth. Peel away paper liner on tape strip on hearth. (Figure 6)

Step #4A. To install Pad, place it on hearth making sure front inside edge of Pad is pressed firmly against front edge of hearth as you lower it down onto hearth. (Figure 7)

Step #5A. With front of Pad attached to hearth, peel away liner from tape along back edge of Pad and press firmly to attach the Pad to hearth. (Figure 7) **Note: Allow 8 to 10 hours for adhesive to completely bond.**

Pad Cutting Instructions.

- 1) Place Pad on top of shipping box or some other flat surface so that when you cut through Pad, the knife will not damage your floor or hearth below.
- 2) Lay straight edge on top of Pad and line it up with marks.
- 3) Using a sharp razor knife, hold it next to straight edge and cut through Pad using light to medium pressure. For best looking cut, make multiple passes along straight edge until you have cut through Pad. DO NOT try to cut through the Pad in one or two passes. Trying to cut pad in one pass may result in jagged cut.

Note: The Soft Seat Hearth Pad is made from a durable, non-slip material that is designed to last for years.

Step: 9 Join Corners to Center Connector with 2" wide tape. (Item D)

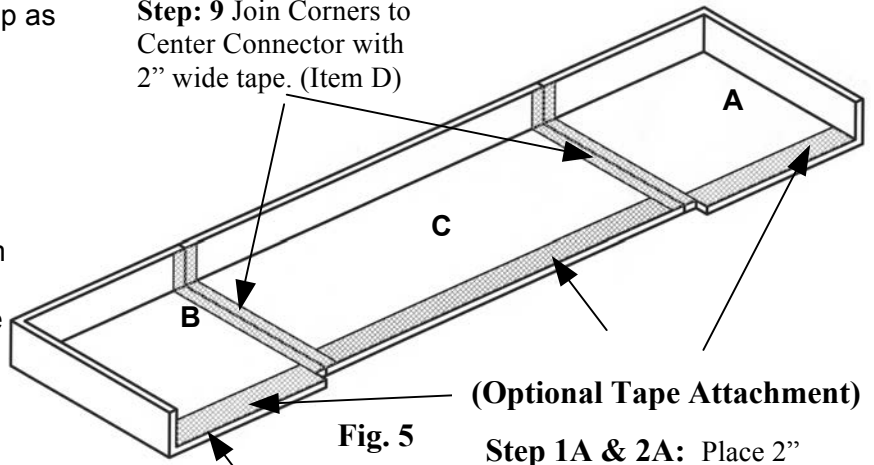

Clean Pad with rubbing alcohol prior to applying tape.

Step 1A & 2A: Place 2" wide attachment tape strips on Pad.

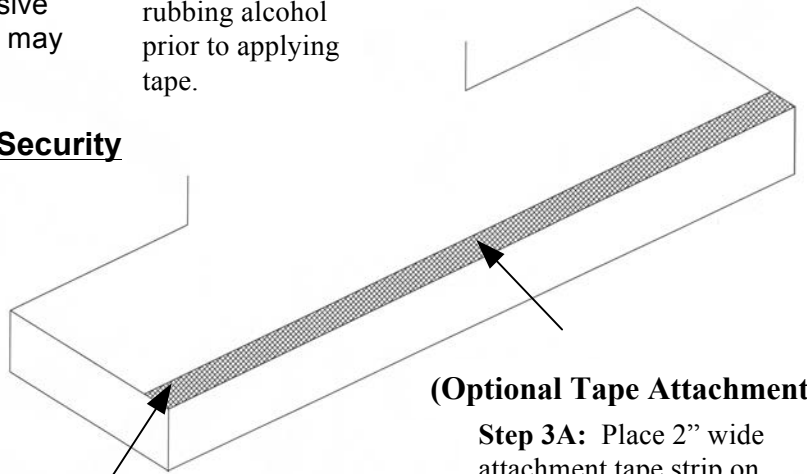

Clean hearth edge with rubbing alcohol prior to applying tape.

Step 3A: Place 2" wide attachment tape strip on hearth (Optional)

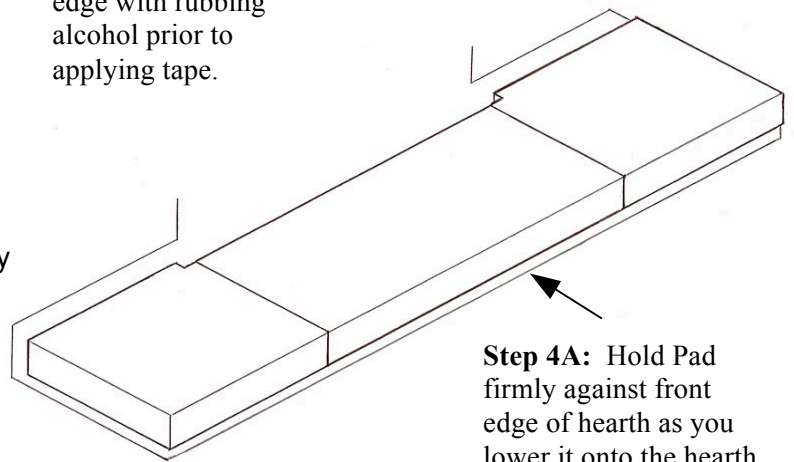

Fig. 7

CUSTOMER SERVICE: KidKusion, Inc., PO Box 1686
 W. Leno, NC 27020