

Safety Innovations™

Billerica, MA 01821 800-598-8911

INSTRUCTIONS FOR INSTALLING THE DELUXE FURNITURE/TV STRAP #666

Tools Needed

Phillips screwdriver, ruler, drill and pencil. Also recommended-electronic stud-finder. Note: studs are usually on 16" centers.

To Install TV to Wall

Do not use this method if the stand is unstable. It may be necessary to install a second set of straps to avoid possible TV stand tip over. TV should not extend beyond the width of the surface on which it is placed.

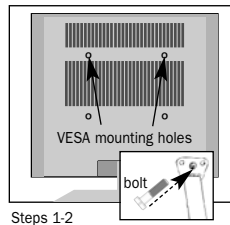

1. Locate upper VESA mounting holes on back of flat screen TV. You will be attaching the straps to them.

2. Determine correct bolt size. Place bolts and washers (if necessary) through the center hole on the metal cleat (long strap end) and tighten to VESA mounting hole. *Washers must be used for the two smaller bolt sizes.*

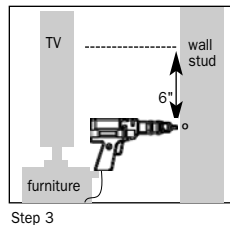

3. Using a stud finder, locate wall studs behind the TV and mark them approximately 6" below the height of the position of the cleat attached to the TV. Mount each strap (buckle end – center hole) to a separate stud using the 2 ½" screw provided. It is necessary to predrill a pilot hole.

4. Tighten each strap by pulling upward. Pull free end of webbing until there is no slack.

Important: Webbing must be inserted through the underside of buckle for strap to operative effectively.

Note: This product is designed to help minimize accidents and is not a substitute for adult supervision.

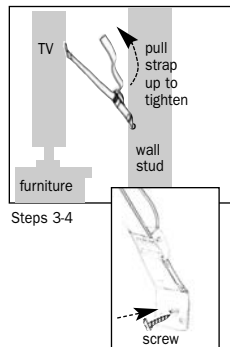

To Install TV To Furniture

Furniture cleat must be screwed into solid surface on the back of furniture. Do not use this method if the stand is unstable or the wood mounting surface is not firm enough to hold the mounting screws securely. It may be necessary to install a second set of straps to the stand itself to avoid tip overs. TV should not extend beyond the width of the surface on which it is placed.

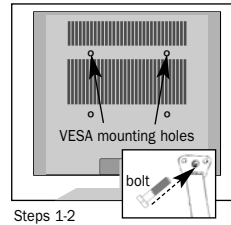

1. Locate upper VESA mounting holes on back of flat screen TV. You will be attaching the straps to them.

2. Determine correct bolt size. Place bolts and washers (if necessary) through the center hole on the metal cleat (long strap end) and tighten to VESA mounting hole. *Washers must be used for the two smaller bolt sizes.*

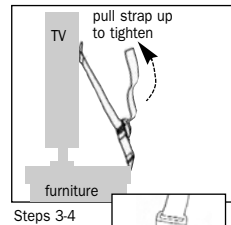

3. Extend both straps downward towards the TV stand. Attach the cleats (buckle end) through the two outside holes using two of the 1" screws provided. Note: It is necessary to predrill a pilot hole to avoid splitting the wood.

4. Tighten each strap by pulling upward. Pull free end of webbing until there is no slack.

Important: Webbing must be inserted through underside of buckle for strap to operative effectively.

Note: This product is designed to help minimize accidents and is not a substitute for adult supervision.

To Install Furniture to Wall

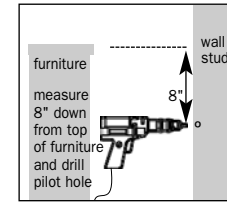

1. Locate wall studs behind furniture. Mark stud locations on wall at top of furniture. Note: Use two straps per piece of furniture when possible. Each strap mounts to a separate stud.

2. Slide item away from wall.

3. Drill a pilot hole into the wall studs about 8" below the top of furniture.

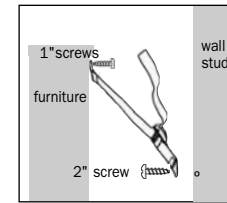

4. Attach the short end of the strap to the wall stud with the 2 ½" screw provided.

5. Using both of the 1" screws, attach the other end of the strap to the top of furniture for tall pieces of furniture (i.e. bookcases) or to the back of furniture for lower pieces (i.e. dressers). Attach where wood is at least ¾" thick.

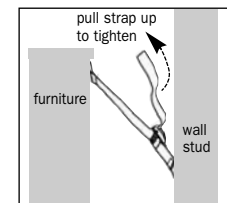

6. Slide furniture back into position and tighten each strap by pulling upward. Pull free end of webbing until there is no slack.

Important: Webbing must be inserted through underside of buckle for strap to operative effectively.

Note: This product is designed to help minimize accidents and is not a substitute for adult supervision.